

## Form A Mounting from Front

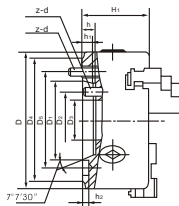

## K11 SERIES DIRECT MOUNTING TYPEA1/A2 THREE-JAW SELF-CENTERING CHUCKS

### SPECIFICATIONS

Form A1 (Use Inner Tapped Holes)

UNIT:mm

Code No	D	D <sub>1</sub>	D <sub>2</sub>	D <sub>3</sub>	D <sub>4</sub>	D <sub>5</sub>	H <sub>1</sub>	h	h <sub>1</sub>	h <sub>2</sub>	d <sub>1</sub>	z-d	Kg Net wt.
K11200 /A1-5 K11200C/A1-5 K11200A/A1-5	200	82.563	61.9	40	133	104.8	84	14.288	12	6.5	16.3	3-M10	17
K11250 /A1-6 K11250C/A1-6 K11250A/A1-6	250	106.375	82.6	55	165	133.4	93	15.875	13	6.5	19.5	6-M12	31
K11325 /A1-6 K11325C/A1-6 K11325A/A1-6	325	106.375	82.6	55	165	133.4	106	15.875	13	6.5	19.5	6-M12	52
K11325 /A1-8 K11325C/A1-8 K11325A/A1-8	325	139.719	111.1	78	210	171.4	106	17.462	14	8	24.2	6-M16	53
K11380 /A1-8 K11380C/A1-8 K11380A/A1-8	380	139.719	111.1	78	210	171.4	118	17.462	14	8	24.2	6-M16	81
K11500A/A1-11	500	196.869	165.1	125	280	235	135	19.050	16	10	29.4	6-M20	159
K11500A/A1-15	500	285.775	247.6	200	380	330.2	135	20.638	17	10	35.7	6-M22	159

### SPECIFICATIONS

Form A2 (Use Outer Tapped Holes)

UNIT:mm

Code No	D	D <sub>1</sub>	D <sub>3</sub>	D <sub>4</sub>	D <sub>5</sub>	H <sub>1</sub>	h	h <sub>1</sub>	h <sub>2</sub>	d <sub>1</sub>	z-d	Kg Net wt.
K11200 /A2-4 K11200C/A2-4 K11200A/A2-4	200	63.513	60	108	86	82.6	-	10	6.5	14.7	3-M10	17
K11500A/A2-11	500	196.869	190	280	135	235	20	16	10	29.4	6-M20	159

## Form C Mounting With Studs and Locknuts

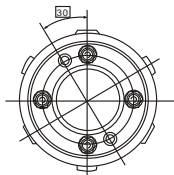
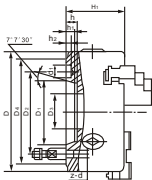

# K11 SERIES DIRECT MOUNTING TYPE C THREE-JAW SELF-CENTERING CHUCKS

## SPECIFICATIONS

UNIT:mm

Code No	D	D1	D2	D3	D4	H1	h	h1	h2	d1	z-d	Kg Net wt.
K11 125/C3	125	53.975	75	25	102	63	13	10	—	—	3-M10	6
K11 125/C4	125	63.513	85	25	112	63	13	10	6.5	14.7	3-M10	6
K11 160/C3 K11 160A/C3	160	53.975	75	40	102	76	13	10	—	—	3-M10	10
K11 160/C4 K11 160A/C4	160	63.513	85	40	112	70	13	10	6.5	14.7	3-M10	10
K11 160/C5 K11 160A/C5	160	82.563	104.8	40	135	73	15	12	6.5	16.3	4-M10	10
K11 200/C4 K11 200C/C4 K11 200A/C4	200	63.513	85	50	112	84	13	10	6.5	14.7	3-M10	17
K11 200/C5 K11 200C/C5 K11 200A/C5	200	82.563	104.8	50	135	84	15	12	6.5	16.3	4-M10	17
K11 200/C6 K11 200C/C6 K11 200A/C6	200	106.375	133.4	50	170	84	16	13	6.5	19.5	4-M12	17
K11 250/C5 K11 250C/C5 K11 250A/C5	250	82.563	104.8	70	135	95	15	12	6.5	16.3	4-M10	30
K11 250/C6 K11 250C/C6 K11 250A/C6	250	106.375	133.4	70	170	95	16	13	6.5	19.5	4-M12	30
K11 250/C8 K11 250C/C8 K11 250A/C8	250	139.719	171.4	80	220	95	18	14	8	24.2	4-M16	30
K11 315/C6 K11 315C/C6 K11 315A/C6	315	106.375	133.4	100	170	103.5	16	13	6.5	19.5	4-M12	53
K11 315/C8 K11 315C/C8 K11 315A/C8	315	139.719	171.4	100	220	106	18	14	8	24.2	4-M16	53
K11 315/C11 K11 315C/C11 K11 315A/C11	315	196.869	235	100	290	106	20	16	10	29.4	6-M20	53
K11 320/C6 K11 320C/C6 K11 320A/C6	315	106.375	133.4	100	170	103.5	16	13	6.5	19.5	4-M12	53
K11 320/C8 K11 320C/C8 K11 320A/C8	315	139.719	171.4	100	220	106	18	14	8	24.2	4-M16	53
K11 320/C11 K11 320C/C11 K11 320A/C11	315	196.869	235	100	290	106	20	16	10	29.4	6-M20	53
K11 325/C6 K11 325C/C6 K11 325A/C6	315	106.375	133.4	100	170	103.5	16	13	6.5	19.5	4-M12	53
K11 325/C8 K11 325C/C8 K11 325A/C8	315	139.719	171.4	100	220	106	18	14	8	24.2	4-M16	53
K11 325/C11 K11 325C/C11 K11 325A/C11	315	196.869	235	100	290	106	20	16	10	29.4	6-M20	53
K11 380/C8 K11 380C/C8 K11 380A/C8	400	139.719	171.4	130	220	118	18	14	8	24.2	4-M16	79
K11 380/C11 K11 380C/C11 K11 380A/C11	400	196.869	235	135	290	118	20	16	10	29.4	6-M20	79
K11 400/C8 K11 400C/C8 K11 400A/C8	400	139.719	171.4	130	220	118	18	14	8	24.2	4-M16	79
K11 400/C11 K11 400C/C11 K11 400A/C11	400	196.869	235	135	290	118	20	16	10	29.4	6-M20	79
K11 500/C11 K11500A/C11	500	196.869	235	190	290	135	20	16	10	29.4	6-M20	159
K11 500/C15 K11500A/C15	500	285.775	330.2	210	400	135	21	17	10	35.7	6-M24	159
K11 630/C11 K11630A/C11	630	196.869	235	252	290	135	20	16	10	29.4	6-M20	230
K11 630/C15 K11630A/C15	630	285.775	330.2	252	400	135	21	17	10	35.7	6-M24	230

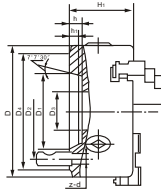
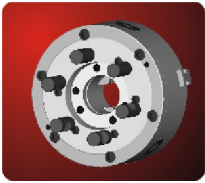

CAMLOCK

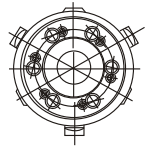

## K11 SERIES DIRECT MOUNTING TYPE D THREE-JAW SELF-CENTERING CHUCKS

### SPECIFICATIONS

UNIT:mm

Code No	D	D1	D2	D3	D4	H1	h	H1	z-d	Kg Net wt.
K11 125/D3	125	53.975	70.6	25	92	63	13	10	3-M10X1	6
K11 125/D4	125	63.513	82.6	25	117	63	13	10	3-M10X1	6
K11 160/D3 K11 160A/D3	160	53.975	70.6	40	92	76	13	10	3-M10X1	10
K11 160/D4 K11 160A/D4	160	63.513	82.6	40	117	70	13	10	3-M10X1	10
K11 160/D5 K11 160A/D5	160	82.563	104.8	40	146	73	15	12	6-M12X1	10
K11 200/D4 K11 200C/D4 K11 200A/D4	200	63.513	82.6	50	117	86	13	10	3-M10X1	17
K11 200/D5 K11 200C/D5 K11 200A/D5	200	82.563	104.8	50	146	86	15	12	6-M12X1	17
K11 200/D6 K11 200C/D6 K11 200A/D6	200	106.375	133.4	50	181	86	16	13	6-M16X1.5	17
K11 250/D5 K11 250C/D5 K11 250A/D5	250	82.563	104.8	70	146	95	15	12	6-M12X1	31
K11 250/D6 K11 250C/D6 K11 250A/D6	250	106.375	133.4	70	181	98	16	13	6-M16X1.5	32
K11 250/D8 K11 250C/D8 K11 250A/D8	250	139.719	171.4	80	225	98	18	14	6-M12X1	32
K11 315/D6 K11 315C/D6 K11 315A/D6	315	106.375	133.4	100	181	103.5	16	13	6-M16X1.5	49
K11 315/D8 K11 315C/D8 K11 315A/D8	315	139.719	171.4	100	225	103.5	18	14	6-M20X1.5	49
K11 315/D11 K11 315C/D11 K11 315A/D11	315	196.869	235	100	298	103.5	20	16	6-M22X1.5	51
K11 320/D6 K11 320C/D6 K11 320A/D6	320	106.375	133.4	100	181	103.5	16	13	6-M16X1.5	50
K11 320/D8 K11 320C/D8 K11 320A/D8	320	139.719	171.4	100	225	103.5	18	14	6-M20X1.5	50
K11 320/D11 K11 320C/D11 K11 320A/D11	320	196.869	235	100	298	103.5	20	16	6-M22X1.5	52
K11 325/D6 K11 325C/D6 K11 325A/D6	325	106.375	133.4	100	181	103.5	16	13	6-M16X1.5	51
K11 325/D8 K11 325C/D8 K11 325A/D8	325	139.719	171.4	100	225	103.5	18	14	6-M20X1.5	51
K11 325/D11 K11 325C/D11 K11 325A/D11	325	196.869	235	100	298	103.5	20	16	6-M22X1.5	53
K11 380/D8 K11 380C/D8 K11 380A/D8	380	139.719	171.4	130	225	118	18	14	6-M20X1.5	81
K11 380/D11 K11 380C/D11 K11 380A/D11	380	196.869	235	135	298	118	20	16	6-M22X1.5	81
K11 400/D8 K11 400C/D8 K11 400A/D8	400	139.719	171.4	130	225	118	18	14	6-M20X1.5	81
K11 400/D11 K11 400C/D11 K11 400A/D11	400	196.869	235	135	298	118	20	16	6-M22X1.5	81
K11 500/D11 K11500A/D11	500	196.869	235	190	298	135	20	16	6-M22X1.5	159
K11-500/D15 K11500A/D15	500	285.775	330.2	210	403	135	21	17	6-M24X1.5	159
K11 630/D11 K11630A/D11	630	196.869	235	252	298	155	20	16	6-M22X1.5	250
K11-630/D15 K11630A/D15	630	285.775	330.2	252	403	155	21	17	6-M24X1.5	250