

KB SERIES LATHE CHUCKS WITH MORSE TAPER

Designed for turning ,milling and grinding operations for simultaneously supporting and clamping long objects (tubes,shafts ect.)
May work in horizontal and vertical position.

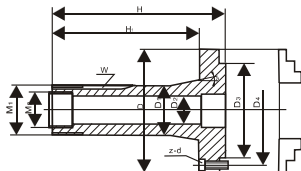

SPECIFICATIONS

UNIT: m m

Size	D	D1	D2	D3	D4	a	M1	M2	W	H	H1	Z-d	Kg Net WT.	Code No
3"	80	31.737	19.45	55	66	10°	1.238"-20NS	1.042"-24NS	3.175 Key groove width	105	86.12	3-M6	2.9	KB11-3"
4"	100	31.737	19.45	72	84	10°	1.238"-20NS	1.042"-24NS		105	86.12	3-M8	4.6	KB11-4"
3"	80	31.737	19.45	55	66	10°	1.238"-20NS	1.042"-24NS		105	86.12	4-M6	2.5	KB11-3"
4"	100	31.737	19.45	72	84	10°	1.238"-20NS	1.042"-24NS		105	86.12	4-M8	3.1	KB11-4"

FK01 SERIES ROTARY&TILT TABLE CHUCKS

SPECIFICATIONS

UNIT: m m

Chuck Outer Dia.	Through-hole Dia.	Center Height	Tilting Range	Rotary Graduation	Code No
110	25	70	0° - 90°	0° - 360°	FK01-110B

- o The chucks are special attachments for engraving machine as well as the common accessories for general machine tool.
- o The functions include indexing and rotating in two directions.
- o Suitable for machining bar,plate,sleeve components for cutting and engraving.

